

# FROM SHADOWS TO INNOVATION.

VEGA OMGATES

"EXPERIENCE THE MOST REVOLUTIONARY  
SPEED GATE ON THE MARKET."



# FEATURE, I

VEGA OMGATES | 5 YEARS, TOP QUALITY

The Speed Gate is popular for its sleek, modern design and high-end aluminum alloy finish, featuring high-end aluminum alloy appearance. It is highly favored for its elegant and luxurious application in access control.

## FLEXIBLE DIMENSIONS

Adaptable passage widths  
from 600 to 1200 mm  
for different traffic.

## ANTI-INTRUSION DOORS

Special doors to avoid unauthorized  
access, enhancing the doors covering  
the top of the turnstile.

## ADVANCED DETECTION 33 PAIRS OF SENSORS

Highly sensitive infrared sensors  
that detect intrusions and reverse  
entries.



# FEATURE, II

VEGA OMGATES | 5 YEARS, TOP QUALITY

## LUXURY ALUMINUM COATING

The aluminum version for inside includes a top quality material that is fingerprint resistant.

## CONTROL BOARD INTEGRABLE

The control board can be integrated into the cabinet, eliminating the need for external installation. This simplifies maintenance and reduces installation costs.

## ANTI INTRUSION SPECIAL DOORS SHAPE

Configurable arms up to 1800mm to reinforce security.

The turnstile includes blue, green and red LED strips that change according to the passing status.

The oscillating barrier rises from the top of the cabinet, enhancing user safety.

Card reader. Color change according to passing status.

High-end aluminum alloy replaces traditional stainless steel for a more elegant and lightweight design.



# ACCESS CONTROL SYSTEM,

VEGA OMGATES | 5 YEARS, TOP QUALITY



**STANDBY  
MODE**



**ACCESS  
GRANTED**



**ACCESS  
DENIED**



**STANDARD GLASS**  
PASSAGE 600-1200 MM



**HIGH GLASS**  
PASSAGE 600-900 MM



**ANTI- CLIMB ARM**  
PASSAGE 600-900 MM





# ACCESS CONTROL SYSTEM,

VEGA OMGATES | 5 YEARS, TOP QUALITY



# ACCESS CONTROL SYSTEM,

VEGA OMGATES | 5 YEARS, TOP QUALITY

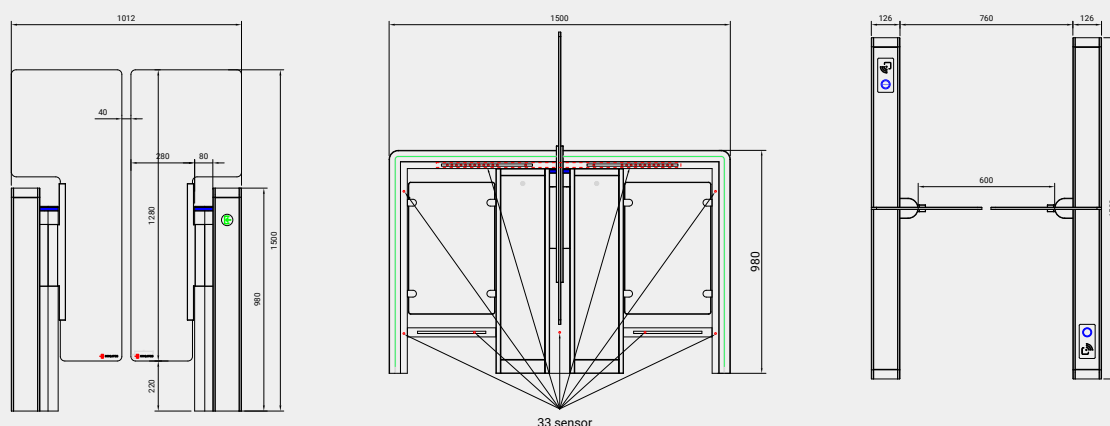

● FRAMEWORK MATERIAL	PREMIUM ALUMINIUM OR STAINLESS STEEL 304 OR 316
ARM MATERIAL	PLEXIGLAS - TRANSPARENCY
DIMENSION	1500 * 126 * 980MM
NET WEIGHT	80 KG/PCS (SINGLE CORE), 100 KG/PCS (DOUBLE CORE)
PASSAGE WIDTH	600MM (STANDARD), 1200MM MAX.
ARM HEIGHT	900MM (STANDARD), 1800MM MAX. (OPTIONAL)
PASSING DIRECTION	SINGLE DIRECTIONAL / BI-DIRECTIONAL
● MCBF	15 MILLION
● POWER SUPPLY	AC220V/110V, 50/60HZ
OPERATION VOLTAGE	24V DC
POWER CONSUMPTION	40 W
● OPERATION TEMPERATURE	-20 °C ~ 75 °C
OPERATION HUMIDITY	0 ~ 95% (NO FREEZE)
WORKING ENVIRONMENT	INDOOR / OUTDOOR (SHELTER)
● PROTECTION INDEX	IP65 (WATER RESISTANT)
● FLOW RATE	55 PEOPLE PER MINUTE
LED INDICATOR	TOP, SIDE AND ARM / BLUE, POWER ON - GREEN - ENTRY - RED, NO ENTRY
● INFRARED SENSOR	33 PAIRS (IT CAN SENSE VARIOUS SITUATIONS VERY WELL)
EMERGENCY	AUTOMATIC ARM OPEN WHEN POWER ON
COMMUNICATION	DRY CONTACT, RELAY SIGNAL, RS485
CARD READER MOUNT	UNDER THE TOP OF THE CABINET, MAX. DIMENSIONS: 110 * 65 * 30MM
● FLEXIBILITY	PLACE TO INTEGRATE THE CONTROL BOARD "INSIDE" THE TURNSTILE

# THE FUTURE HAS COME. WELCOME TO A NEW ERA...

OMGATES.COM | HIGH TECHNOLOGY. MADE TO LAST...



ALIEN TECHNOLOGY